



Flat for Sale

Abbeyfield Estate, Bermondsey, London, SE16 2EZ



Key Features

- Ground Floor Flat
- Well Presented
- Long Lease remaining
- Front Patio Area
- Rear Garden
- Close to Local Amenities

£205,000

Description

GUIDE PRICE: £205,000 - £225,000

TMV are proud to bring to market this extremely well presented ground floor flat, located in a quiet residential area of Bermondsey. The property benefits from a modern separate kitchen, bright living room and plenty of storage throughout. Additional benefits include a front patio area and also access to a rear garden.

Bermondsey Station (Zone 2) is within walking distance providing excellent transport links to the City and West End.







Damory House, SE16

CAPTURE DATE 08/09/2021 LASER SCAN POINTS 1,614,771

GROSS INTERNAL AREA

30.89 sqm / 332.50 sqft

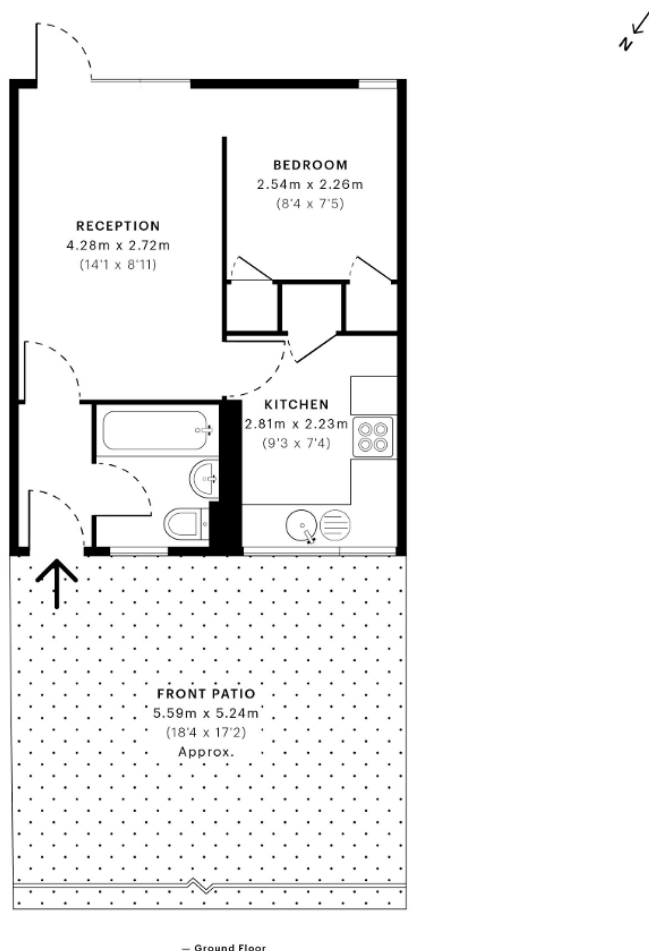

GROSS INTERNAL AREA (GIA)
The footprint of the property
30.89 sqm / 332.50 sqft

NET INTERNAL AREA (NIA)
Excludes walls and external features
Includes warehouse, restricted head height
29.38 sqm / 316.24 sqft

EXTERNAL STRUCTURAL FEATURES
Balconies, terraces, verandas etc.
0.00 sqm / 0.00 sqft

RESTRICTED HEAD HEIGHT
Limited use area under 1.5 m
0.00 sqm / 0.00 sqft



Spec Verified floor plans are produced in accordance with Royal Institution of Chartered Surveyors' Property Measurement Standards. Plots and gardens are illustrative only and excluded from all area calculations. Due to rounding, numbers may not add up precisely. All measurements shown for the individual room lengths and widths are the maximum points of measurements captured in the scan.

IPMS 3B RESIDENTIAL 31.02 sqm / 333.90 sqft
IPMS 3C RESIDENTIAL 29.59 sqm / 318.50 sqft

SPEC ID: 613768c999595e0de047de54

Disclaimer: These particulars are thought to be materially correct though their accuracy is not guaranteed and they do not form part of any contract. All measurements are approximate and we have not tested any fitted appliances, electrical or plumbing installation or central heating systems.